



WATER PUMP

SERIES



THERMIC-WATER PUMP SERIES

Water pump for massage bathtub and SPA circulation pump

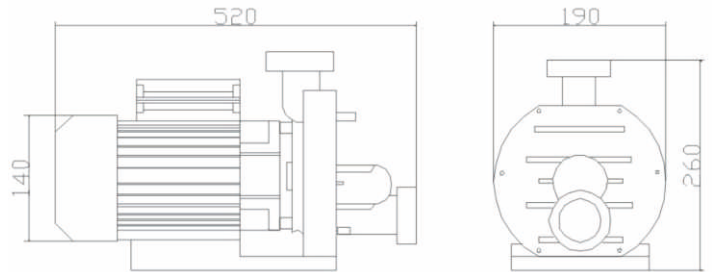

Technical data

Model	Power (HP)	Rated Voltage	Pipe Diameter (inch/mm)	Phase (N~)	Maximum Flow (L/min)	Maximum Lift(m)
SYL140-I2-100	1	220V 50HZ	1.5/50	1~	275	11
SYL140-I3-100	1	380V 50HZ	1.5/50	3~	275	11
SYL140-I2-56	0.75	220V 50HZ	1.5/50	1~	240	10.5
SYL140-I2-35	0.5	220V 50HZ	1.5/50	1~	240	10

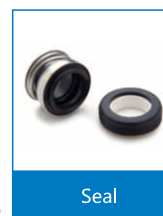
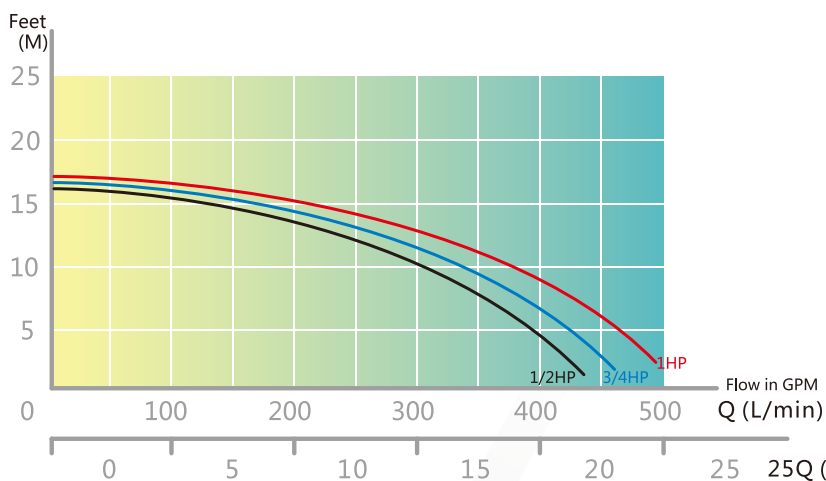

THERMIC-WATER PUMP/ SWIMMING POOL PUMP

KE-35S KE-50S KE-75S KE-100S KE-120S

KE-150S KE-200S KE-250S KE-300S



Dimension chart

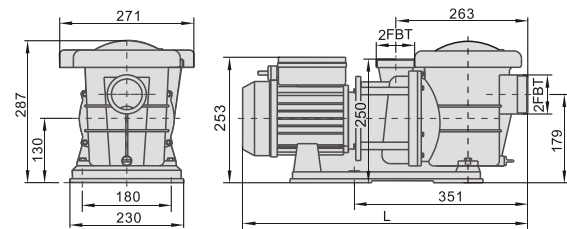
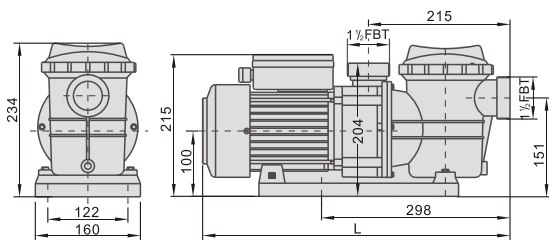

Technical data

Model	Power(KW/HP)	Rated Voltage	Current(A)	Qmax(l/min)	Pipe Diameter	(KG)
KE-35S	0.25/0.35	220-240V/50Hz	1.6	160	48.5or50	6.5
KE-50S	0.37/0.5	220-240V/50Hz	2.0	210	48.5or50	7
KE-75S	0.55/0.75	220-240V/50Hz	3.2	240	48.5or50	8.8
KE-100S	0.75/1.0	220-240V/50Hz	3.8	275	48.5or50	9.5
KE-120S	0.9/1.2	220-240V/50Hz	4.6	300	48.5or50	9.8
KE-150S	1.1/1.5	220-240V/50Hz	5.8	430	60.3or63	14
KE-200S	1.5/2.0	220-240V/50Hz	7.0	520	60.3or63	15.5
KE-250S	1.85/2.5	220-240V/50Hz	8.5	600	60.3or63	16.5
KE-300S	2.2/3.0	220-240V/50Hz	10	635	60.3or63	18

Performance curves

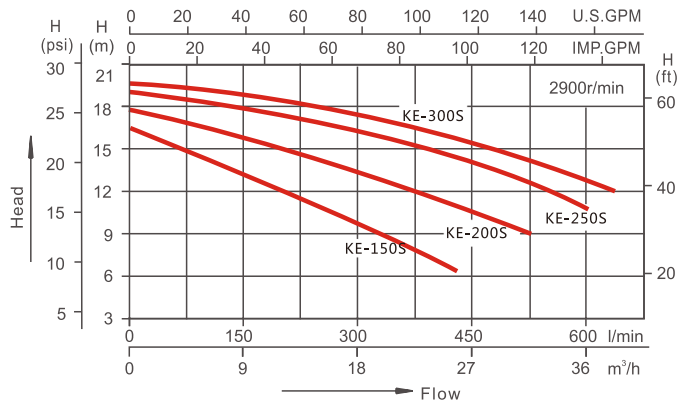
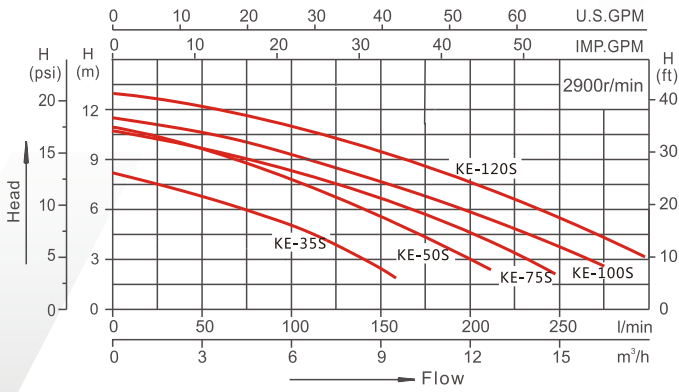

Air Pump



220V Air pump



380V Air pump

Number	Model	Motor(HP)	Rating Power	Maximum wind pressure(kpa)	Vacuum (-kpa)	Maximum wind volume(m³/h)	Rating current (A)
1	HCY-550-C	0.75	220V/50HZ	15	12	95	3.6
2	HCY-750-C	1	220V/50HZ	16	14	110	4.3
3	HCY-1100-C	1.5	220V/50HZ	22	18	180	8.4
4	HCY-1100-C2	1.5	380V/50HZ	22	20	135	2.8
5	HCY-1500-C	2	220V/50HZ	22	18	218	15.5
6	HCY-1500-C2	2	380V/50HZ	24	20	170	3.4
7	HCY-2200-C	3	380V/50HZ	33	25	260	4.7



THERMIC

THERMIC HEAT TRANSFER PTY LTD
140 COURTENAY AVE, CRANBOURNE NORTH VIC 3977, AUSTRALIA

www.thermic-heattransfer.com.au